

NOTES:

- REFER TO LANDSCAPE PLAN FOR DETAILS
- REFER TO STORMWATER PLAN FOR STORMWATER DETAILS / SEDIMENT AND EROSION CONTROL PLAN
- REFER TO STRUCTURAL PLAN FOR RETAINING WALL DETAILS
- REFER TO STORMWATER PLAN AND BASIX REPORT FOR RAINWATER TANK DETAILS
- ALL BOUNDARY FENCING TO BE MAINTAINED OR CONSTRUCTED AT A HEIGHT OF 1800mm ABOVE NGL

SITE CALCULATIONS

| | |
|-------------------------|------------|
| SITE AREA | 483.1 sqm |
| GROUND FLOOR AREA | 131.24sqm |
| FIRST FLOOR AREA | 115.76sqm |
| TOTAL FLOOR AREA | 247.00sqm |
| FLOOR SPACE RATIO | 0.51:1 |
| MAX FLOOR SPACE RATIO | 0.55:1 |
| SITE COVERAGE | 215.83 sqm |
| MAX SITE COVERAGE (50%) | 241.55sqm |
| IMPERVIOUS AREA | 338.43sqm |
| DEEP SOIL AREA | 105.81sqm |
| MIN DEEP SOIL AREA 20% | 96.62sqm |

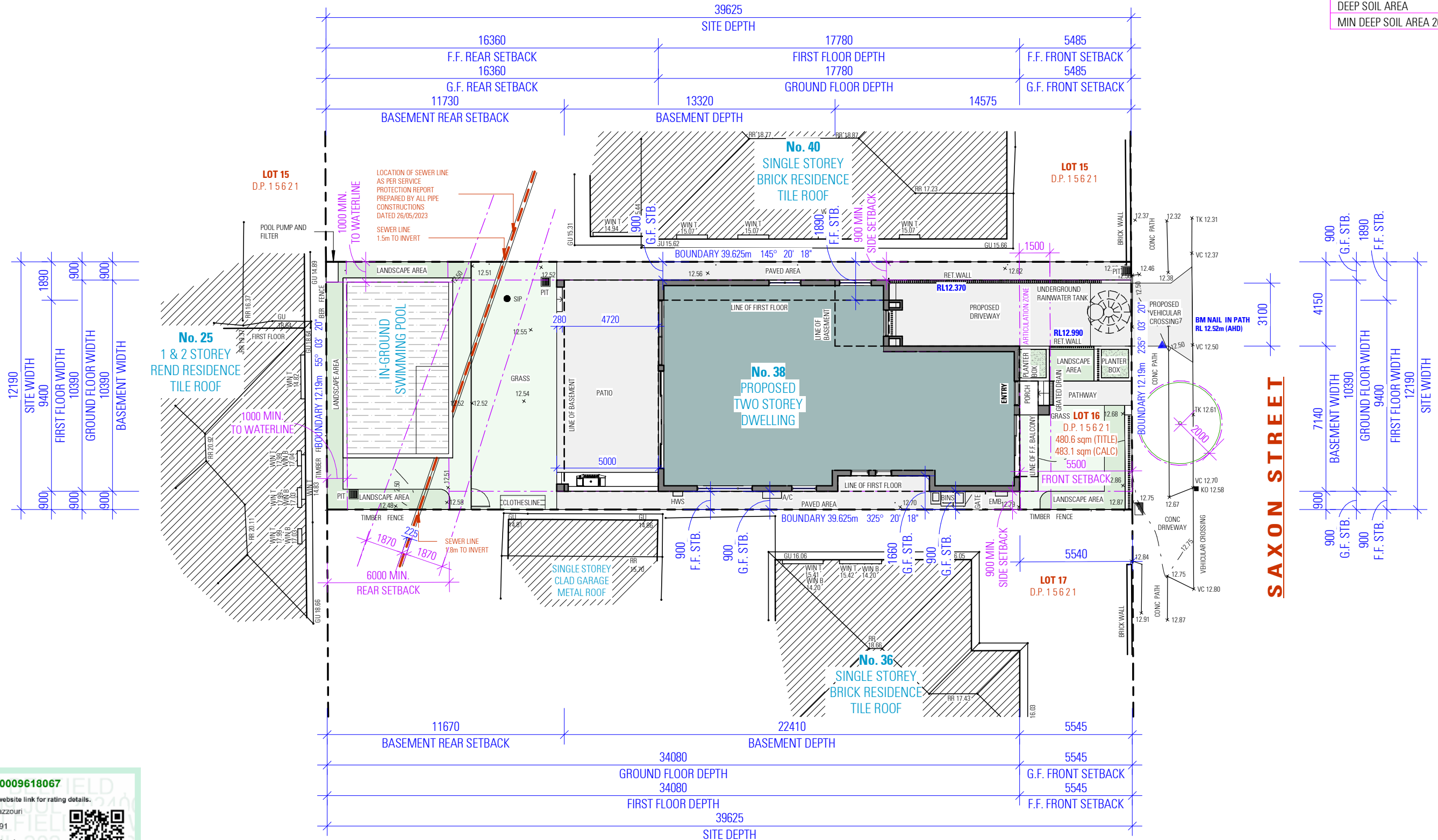

SAXON STREET

PROPOSED SITE PLAN

NOT FOR CONSTRUCTION

Certificate No. 0009618067

Scan QR code or follow website link for rating details.

Assessor name: Noura Al Hazzouri

Accreditation No. DMN/18/1891

Property Address: 38 Saxon Street, BELFIELD, NSW, 2191

SITE LEGEND

| ITEM | SYMBOL |
|---------------------|--------|
| GROUND FLOOR AREA | |
| LINE OF FIRST FLOOR | |
| SITE BOUNDARY | |

NOTES

1. ALL DIMENSIONS ARE IN MILLIMETERS
2. VERIFY ALL DIMENSIONS ON SITE
3. DO NOT SCALE, USE FIGURED DIMENSIONS ONLY
4. VERIFY ALL DISCREPANCIES WITH THE DESIGNER
5. ALL WORKS TO COMPLY WITH THE NATIONAL CONSTRUCTION CODE (B.C.A) & AUSTRALIAN STANDARDS

COPYRIGHT

THESE DRAWINGS HAVE BEEN PREPARED BY ES DESIGN, AND SHALL REMAIN THE PROPERTY OF THE SAME. NO PORTION OF THESE DRAWINGS, WHETHER IN PART OR WHOLE, SHALL BE USED IN ANY FORM, DUPLICATED OR OTHERWISE, WITHOUT PRIOR WRITTEN PERMISSION OF THE ARCHITECT/DESIGNER. THESE DRAWINGS ARE SUBJECT TO COPYRIGHT LAWS.



PROPOSED TWO STOREY DWELLING

38 SAXON STREET
BELFIELD NSW 2191

DESIGN: CLARE FAULKNER
DRAFTED: IRENA MILOJEVSKA

BILL MALLOUHI

DRAWING

PROPOSED SITE PLAN

SCALE: 1:200/A3
ISSUE: 24.07.2024

DWG No. 22276 - 03